

THE ORIGINAL PORTABLE HOIST

Genie Industries began in 1966 with the original Genie® Hoist — a unique portable pneumatic lift that was so successful, it launched the development of a full range of material hoists and aerial work platforms. Today's Genie® Super Hoist™ continues the legacy of innovation with an incredibly compact, easy-to-use design. This portable telescoping pneumatic hoist uses CO₂ or compressed air to lift up to 300 lbs (136 kg) to heights of 12 ft 5.6 in (3.8 m) or up to 250 lbs (113 kg) up to 18 ft 4.5 in (5.6 m).

FLEXIBLE POWER

The hoist is powered by either CO₂ or compressed air and provides approximately 80 to 90 lifts from a single tank of CO₂. The “one size fits all” bottle mounting bracket accepts any common CO₂ bottle size. A 20 lb (9 kg) CO₂ tank is also available as an accessory. The hose stretches 16 ft (4.87 m) for added mobility and stores around brackets underneath the platform when not in use.



EASY OPERATION

Up and down functions, including the dump valve, can all be activated from the patented pistol-grip control handle, which clips to a storage button on the side of the cylinder when not in use.

Lightweight, compact and portable, this telescoping pneumatic hoist allows an individual to lift heavy loads into place for installation.



PLATFORM CRADLE PACKAGE

Available as an accessory to handle odd-shaped items.

VERSATILE APPLICATIONS

Lift, position and install a wide variety of materials, including metal and fiberboard air ducts, overhead sprinklers/plumbing, drywall and ceiling panels, and electrical fixtures.

QUICK, EASY SETUP

Sets up in seconds — no special tools required. The one-piece platform attaches to the cylinder with a twist of the wrist. Legs fold out from the base, and the lock mechanism keeps each leg out for use (or up for storage). Casters also lock in place with the touch of a toe.

LIGHTWEIGHT, COMPACT DESIGN

The compact size and weight allow one person to lift and move heavy loads, yet quickly move from job to job. The hoist is completely portable and easy to store and transport. It's so lightweight and compact, it fits in the trunk of most cars.



GENIE® SUPER HOIST™ MODELS AVAILABLE

GH™ 3.8 | GH™ 5.6

Features

EASILY CONFIGURED TO MEET YOUR NEEDS

PLATFORM OPTIONS

- One-piece platform
- Platform cradle package

POWER

- Compressed air - CO₂

BASE OPTIONS

- GH 3.8
- GH 5.6

OPTIONS & ACCESSORIES

PRODUCTIVITY

- Platform cradle package

POWER

- 20 lbs (9 kg) CO₂ tank with regulator

STANDARD FEATURES

MEASUREMENTS

GH™-3.8

- 12 ft 5.6 in (3.80 m) lifting height
- 300 lb (136 kg) load capacity

GH™-5.6

- 18 ft 4.5 in (5.60 m) lifting height
- 250 lb (113 kg) load capacity

PRODUCTIVITY

- Portable and compact design
- Up and down dump valve can be easily activated by patented control handle
- The Super Hoist sets up in seconds — no tools required
- The one-piece platform attaches to cylinder with a twist of the wrist
- Legs fold up for easy storage
- Easy-to-release leg lock keeps legs up for storage and out for use
- Wheel brakes
- Auto-lubricating oil reservoir on top of each piston inside the cylinder
- Easy to service

POWER

- Powered by CO₂ or compressed air
- One size fits all CO₂ bottle mounting bracket



Specifications

MODELS	GH™-3.8		GH™-5.6	
MEASUREMENTS	US	Metric	US	Metric
A Height - stowed	3 ft 5 in	1.04 m	4 ft 6 in	1.37 m
- lifting height	12 ft 5.6 in	3.80 m	18 ft 4.5 in	5.60 m
B Length - platform	1 ft 7 in	.48 m	1 ft 7 in	.48 m
C Width - platform	2 ft	.61 m	2 ft	.61 m
D - base (corner to corner)	4 ft 5 in	1.35 m	4 ft 5 in	1.35 m
PRODUCTIVITY				
Load capacity	300 lbs	136 kg	250 lbs	113 kg
Storage/transport dimensions	14x14x39.5 in	.36x.36x1 m	14x14x39.5 in	.36x.36x1 m
POWER				
Recommended PSI	85 psi	5.86 bar	85 psi	5.86 bar
WEIGHT*				
	75 lbs	34 kg	82 lbs	37 kg

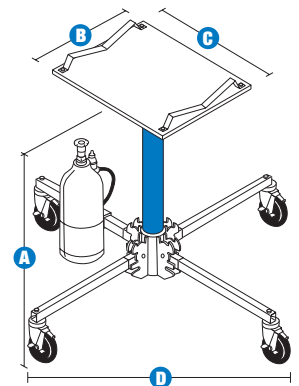

* Weight will vary depending on options and/or country standards.

Working At Height Limited

(Southern Office)
Amberley Court
Old Elstead Road
Milford
Surrey
GU8 5EB

Tel: 01483 415 410
Fax: 01483 417 719

Working At Height Limited

(Northern Office)
The Portergate
Ecclesall Road
Sheffield
South Yorkshire
S11 8NX

Tel: 0114 209 6206
Fax: 0114 209 6001

Suppliers of:

Powered Access Platforms
Aerial Work Platforms
Runabout Access Platforms
Scissor Lifts
Articulating Boom Access Platforms
Telescopic Boom Access Platforms
Material Lifts
Telehandlers
MEWPS Training